

Data sheet

Support roller NATR 40 (crowned, with axial guidance, cage)

Designation	NATR 40
Type	crowned
D [mm]	80
d [mm]	40
d1 [mm max.]	66
B1 [mm]	29
B [mm]	30
r [mm]	1,1
Dynamic load Crw[N]	33000
Static load C0rw[N]	59000
Speed limit [min-1]	1700
Speed limit [min-1]	1700

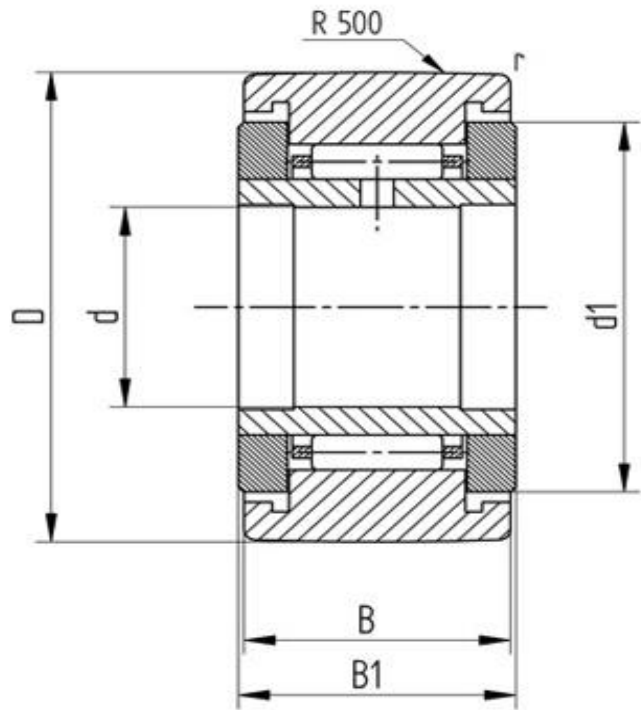

Every specification has been edited and verified carefully. STI Bearings GmbH assumes no liability for potential errors or incompleteness. Technical modifications are subject of changes.

© 2020 by STI Bearings GmbH
Reproduction, even excerpts, only with our approval.